

## 2.39

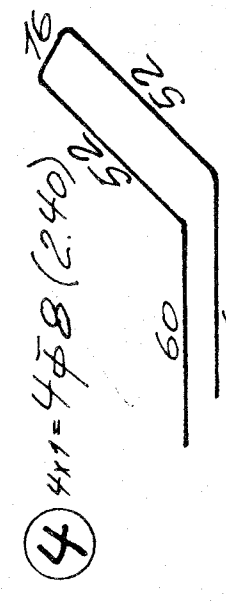

SCHNITT 3-3

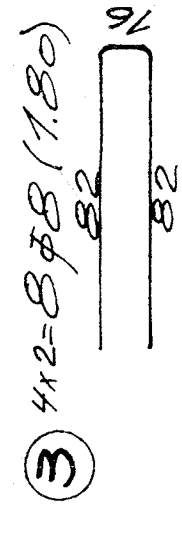
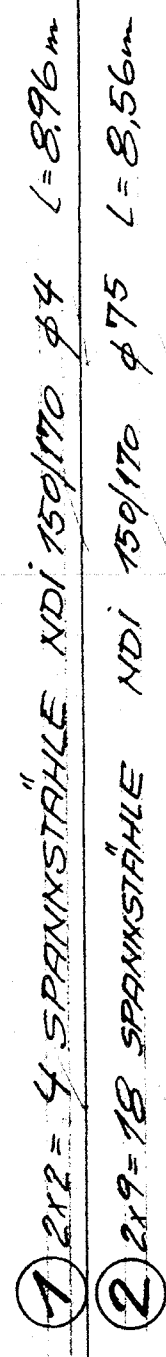
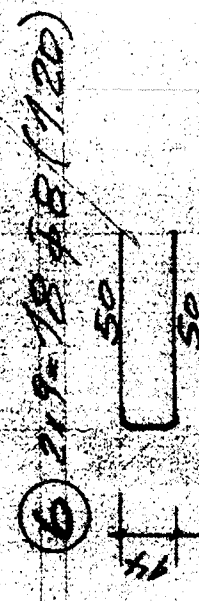
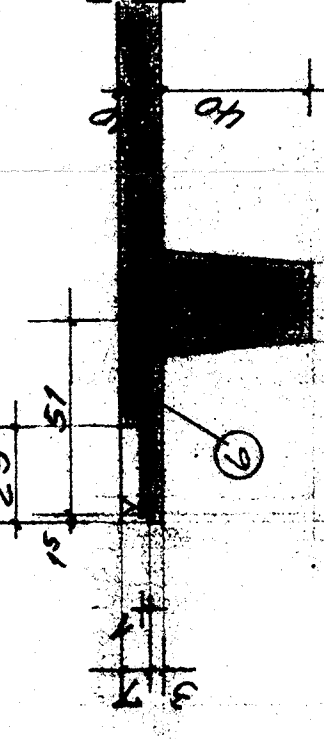

**WÜRFELFESTIGKEIT  
BEIM VORSPANNEN**

UNTEN:  $\sigma_Z = 4,376 \text{ Mp/STAHl}$   
 $\Sigma = 78,768 \text{ Mp}$

[illegible]

BSTG - ZEICHNUNGSMATTEN

- ①  $1 \times (250 \cdot 150 \cdot 40 \cdot 40) 8.9 \times 2.30 \text{ m}$   
②  $1 \times (250 \cdot 150 \cdot 40 \cdot 40) 8.9 \times 2.30 \text{ m}$